

HABITAT

ROAD LIFE | 

15 Birch Ave Tauranga - www.roadlife.co.nz - 07 579 6489



GO FURTHER STAY LONGER

A multi-terrain masterpiece. The Habitat is a touring motorhome designed for the free camper who wants to travel further, camp more remotely and stay longer.

FEATURES

- **Multi-Terrain-** With features such as higher ground clearance, all terrain tyres, checker plate finish, increased rear departure angle, and forward protection bar.
- **Take your toys-** The HA1 & HA2 Sunliner Utility Garage allows for some of the greatest storage of any RV on the Australian & New Zealand market.
- **Stay Longer-** Increased fresh water and grey water storage, additional solar panels and battery capacity. Truly allowing you to stay longer.
- **Extra Security-** 360 degree security lighting, UHF radio and forward facing camera with DVR keeping you safe.

KEY INFORMATION

| | HA1 | HA2 | HA3 | HA4 | HA5 |
|----------------|--------|------------------|--------|-----|--------|
| LENGTH | 8.2M | 7.6M | 5.9M | - | 7.1M |
| WIDTH | 2.5M | 2.5M | 2.2M | - | 2.5M |
| HEIGHT | 3.3M | 3.3M | 3.3M | - | 3.3M |
| SLEEPS | 2/4 | 2/4 | 2 | - | 2/4 |
| GVM | 7200kg | 4495kg 7200kg | 3200kg | - | 4495kg |
| LICENCE | HT | HT/Car | CAR | - | CAR |
| UTILITY GARAGE | YES | YES | NO | - | NO |
| UTILITY BAR | YES | YES | - | - | YES |

HA1

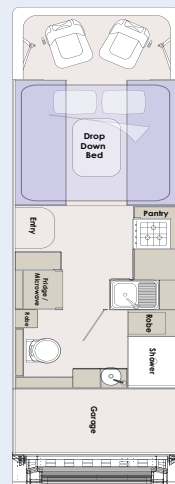

IVECO DAILY 70

HA2



IVECO DAILY 50
IVECO DAILY 70

HA3

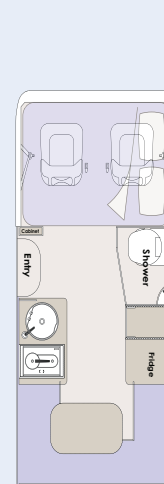

FORD RANGER 4X4

HA4 NOT AVAILABLE THROUGH ROAD LIFE RV

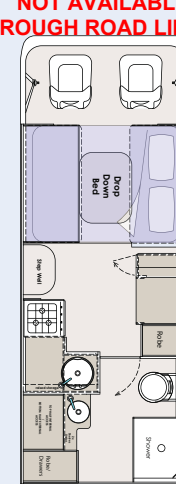

MERCEDES BENZ 519
4X4

HA5



IVECO DAILY 45
IVECO DAILY 50

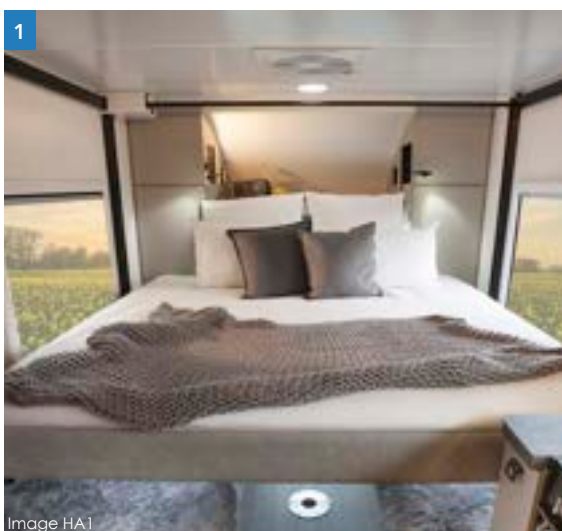

Image HA1



Image HA1



Image HA2



Image HA2

1. Wake to panoramic views out of the large **insulated single hopper windows** from your **North/South electric drop down bed**. 2. Get dressed in privacy in your large bathroom. Ample storage with drawers, overhead lockers and wardrobe 3. Standard in the HA1 & HA2 the **Utility Garage** electric drop-down platform combined with the dual slide sliding deck, allows you to pack for all of your long-term needs. 4. Large ultra leather lounges allow for a roomy dining area and lazy days. They can also double as single beds in the HA1. **Separate fresh water tap** with filter & stove/oven combination completes the modern functional kitchen.

Road Life RV - NZ SPECIFICATIONS - HABITAT

| | HA1 | HA2 | HA3 | HA4 | HA5 |
|---|-----|-----|-----|-----|-----|
| CABIN / CHASSIS | | | | | |
| All Terrain Tyre UPGRADE | • | • | • | - | • |
| Alloy Wheel Upgrade | - | - | • | - | - |
| Blockout Window Thermal Blind Set | • | • | • | - | • |
| DVR Forward Camera Recorder | • | • | • | - | • |
| Front Protection Nudge Bar | • | • | • | - | • |
| Iveco 210lt Fuel Tank Upgrade | • | - | - | - | - |
| Light Bar 22" | • | • | • | - | • |
| Reverse Camera | • | • | • | - | • |
| Swivel Driver & Passenger Seat | • | • | - | - | • |
| UHF CB Radio | • | • | • | - | • |
| CLIMATE CONTROL | | | | | |
| Air Conditioner 2400W | • | • | • | - | • |
| Diesel Heater | • | • | • | - | • |
| Roof FAN Bathroom Hatch | • | • | • | - | • |
| Roof FAN Hatch Fiamma Turbo | • | • | • | - | • |
| ELECTRICAL LIGHTING | | | | | |
| Boot Light With Switch | - | - | • | - | - |
| External Security Lighting Roof Light Bar 22 Inch | 3 | 3 | - | - | 3 |
| LED Strip In Step Well | • | • | • | - | • |
| Reading Lights | - | - | 2 | - | - |
| ELECTRICAL POWER SYSTEMS | | | | | |
| 12V BMS Control System Redarc | • | • | • | - | • |
| Battery 135 LITHIUM | 3 | 3 | 2 | - | 2 |
| Double USB + 12v Socket | • | • | • | - | • |
| External 240 Power Inlet | • | • | • | - | • |
| External 240 Power Outlet | • | • | • | - | • |
| Generator 2.3 KVA | • | - | - | - | - |
| Inverter 2000w Pure Sign Wave | - | - | • | - | - |
| Inverter 3000w Pure Sign Wave | • | • | - | - | • |
| Solar Panel 170w | 3 | 2 | 1 | - | 2 |
| ENTERTAINMENT | | | | | |
| Speakers External Pair | • | • | • | - | • |
| Speakers Internal Pair | • | • | • | - | • |
| Stereo Fusion MS-RA55 | - | • | • | - | • |
| Stereo Fusion MS-RA770 | • | - | - | - | - |
| Automatic Satellite Dish | • | • | • | - | • |
| Satellite TV | • | • | • | - | • |
| EXTERNAL | | | | | |
| Entry Step Electric | • | • | • | - | • |
| External Table | • | • | • | - | • |
| Roof Bars | • | • | • | - | • |
| EXTERNAL AWNINGS MAIN | | | | | |
| Electric | • | • | - | - | • |
| Wind Out | - | - | • | - | - |
| EXTERNAL STEEL COMPONENTS | | | | | |
| Cabin Side Steps Steel | • | • | • | - | • |
| Utility Bar | • | • | - | - | • |
| HANDLES | | | | | |
| External Entry Illuminated | • | • | • | - | • |
| Internal Entry Large Wave | • | • | - | - | • |
| Positive Catch Handles | • | • | • | - | • |
| KITCHEN | | | | | |
| 3 Gas Burner + Oven And Grill Combo | • | • | - | - | • |
| 3 Gas Cooker | - | - | • | - | - |
| Bench Extension | - | - | • | - | - |
| Microwave | • | • | • | - | • |
| Rangehood | • | • | • | - | • |
| Sink Round With Lid | - | • | • | - | • |
| Sink With Drainboard | • | - | - | - | - |
| Splashback | • | • | • | - | • |

| | HA1 | HA2 | HA3 | HA4 | HA5 |
|-----------------------------------|-----|-----|-----|-----|-----|
| Water Purifier With Separate Tap | • | • | • | - | • |
| 2 Way 150L | - | - | - | - | - |
| 2 Way 185L | • | • | - | - | • |
| 2 Way 90L | - | - | • | - | - |
| MATTRESS | | | | | |
| Double 4'6" x 6'2" x 6' | - | • | - | - | • |
| Double Foam 1370x1850x100 | - | - | • | - | - |
| King 6' x 6' 2" x 6' | • | - | - | - | - |
| PLUMBING ITEMS | | | | | |
| Toilet Ceramic | • | • | - | - | • |
| Toilet Plastic | - | - | - | - | - |
| Vanity Basin Sink Ceramic | • | • | - | - | • |
| External Mains City Water | • | • | • | - | • |
| External Shower | - | • | • | - | • |
| External Water Filler | • | • | • | - | • |
| Flow Meter For Fresh Water | • | • | • | - | • |
| Gas Bottles 4kg | 2 | 2 | 1 | - | 2 |
| Hot Water Service Gas | • | • | • | - | • |
| Water Pump | • | • | • | - | • |
| PLUMBING TANKS | | | | | |
| Tank Fresh (Ltr) | 300 | 200 | 100 | - | 200 |
| Tank Waste (Ltr) | 200 | 200 | 100 | - | 150 |
| SAFETY | | | | | |
| Fire Extinguisher | • | • | • | - | • |
| Internal Gas Detector Alarm | • | • | • | - | • |
| Internal Smoke Alarm | • | • | • | - | • |
| Internal Step Carpet Mat Sunliner | • | • | • | - | • |

CHASSIS SPECIFICATIONS

| | FORD RANGER- 4X4 HIGH RIDER | IVECO- DAILY 45 C18A8 | IVECO- DAILY 50 C18HA8 | IVECO- DAILY 70 C21HA8/P |
|------------------------------|--------------------------------|--------------------------|---------------------------|-----------------------------|
| Engine | 3.2 Ltr | 3.0 Ltr | 3.0 Ltr | 3.0 Ltr |
| Power (hp/kw) | 197/147 | 176/130 | 180/132 | 210/155 |
| Torque (Nm) | 470 | 400 | 430 | 470 |
| GVM (kg) | 3200 | 4495 | 4495/5200 | 7200 |
| Transmission | 6 Speed Auto | 8 Speed Auto | 8 Speed Auto | 8 Speed Auto |
| Driven Wheels | 4 x 4 | Rear | Rear | Rear |
| Tyre Size | 265/70 R16 | 195/75 R16 | 195/75 R16 | 225/75 R16 |
| Ani-Lock Brakes (ABS) | STD | STD | STD | STD |
| Traction Control | STD | STD | STD | STD |
| Stability Control | STD | STD | STD | STD |
| Warranty Period (Years/Km's) | 5 yr Unlimited | 3 yr/200,000 | 3 yr/200,000 | 3 yr/200,000 |
| Wheel Base | 3220 | 4350 | 4750 | 4750 |
| ECAS | - | - | - | - |
| DIFF LOCK | - | STD | STD | STD |
| Suspension Seats | - | - | STD | STD |

To explore more take a photo of the below QR codes



**MORE
HABITAT**



**IMAGES &
360 TOURS**



ABOUT US



DEALERS



IN STOCK



GARAGE

Due to continuous improvements and availabilities, specifications, inclusions & brands are subject to change without notice. All capacities, weights, lengths and measurements are approximates. Images used may not depict the actual model or may contain items that are not standard or available.

**This document should be used as a guide only.
For more detailed information please contact your local dealer.**

www.sunliner.com.au

